



ELS-24 Heavy Duty P-6043 Telemetry Power Sling Shackle

Euroload Limited provide a range of Heavy Duty load monitoring shackles. Manufactured from Van Beest P-6043 heavy duty power sling shackle as standard. Stainless steel or steel load pins available.

Euroload can manufacture using any manufacturer or style of load shackle for specific applications. Subsea or Hazardous area are also available.

At Euroload we calibrate every load shackle in its bow in tension. We never calibrate load shackle pins on V Blocks in compression. The accuracy is unacceptable calibrated on V blocks.

Euroload load shackles have incredible accuracy and repeatability through years of R and D.

These heavy duty load shackles have been designed to cope with any environment with ease.

The options available for the ELT telemetry output are unsurpassed, from battery operated handsets to receiver modules for analogue output, digital output, gateways, datalogging, large digit displays, printers, etc. See our ELT24 Made to Measure brochure for a full list.

The 2.4 GHz signal is worldwide exempt.

The standard range cover 120 tonne to 2000 tonne. Special's are available on request. These load shackles are utilised in varies industries including, Oil and Gas, Manufacturing, Aerospace, renewables, Fishing, Transportation, Marine.

Anywhere a reliable tensile load reading is required.

Features:

- . ELT24 telemetry output. 2.4 GHz worldwide except
- . Unsurpassed range of receivers and modules
- . Free datalogging software
- . High Grade steel or stainless steel load pins
- . Compact size and low headroom.
- . Exceptional heavy duty stainless steel end cap
- . Dual output available both telemetry and cabled
- . IP67 ingress protection as standard
- . Unique screw off battery compartment
- . Selectable units of measurement
- . Peak hold as standard
- . 2 year manufacturer warranty
- . Manufactured to order
- . Worldwide agent network with stock held

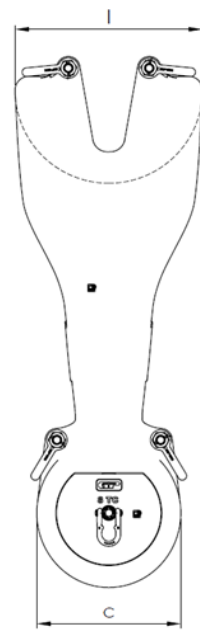
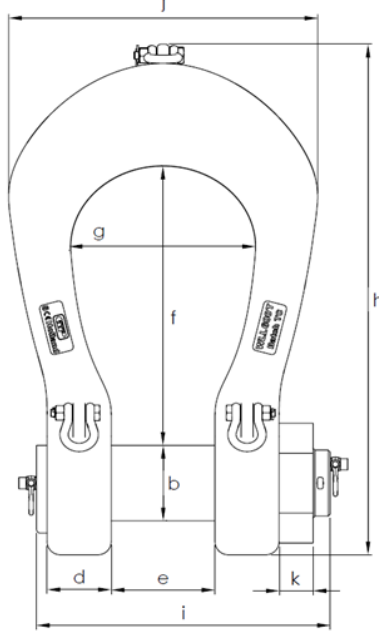

Shackle Dimension`s Van Beest P-6043 Heavy Duty Power Sling Shackle BN

Shackle Size WLL	b	c	d	e	f	g	h	i	j	k	l	m	Weight KG
125	80	166	85	134	364	220	631	382	370	36	205	95	
150	95	182	90	144	389	250	703	408	420	42	248	134	
200	105	204	100	154	479	276	838	446	475	47	290	195	
250	120	238	110	174	539	300	938	503	515	60	314	271	
300	134	260	121	189	599	350	1031	550	605	60	345	368	
400	160	305	140	224	620	370	1123	645	652	80	392	563	
500	180	340	152	255	679	450	1239	714	763	85	440	786	
600	200	365	170	280	739	490	1353	788	820	90	475	1009	
700	215	405	190	320	750	540	1415	879	895	100	512	1288	
800	230	430	200	347	850	554	1547	942	917	108	536	1503	
900	255	476	215	373	850	580	1598	1013	970	120	560	1849	
1000	270	500	232	404	850	614	1642	1085	1022	125	590	2188	
1250	300	570	245	442	928	650	1812	1164	1144	140	670	2933	
1550	320	590	270	475	950	680	1890	1244	1210	106	704	3558	
Material	Bow and Pin alloy steel, grade 8, quenched and tempered, optional stainless steel 17-4 load pin												
Safety Factor	MBL equals 5 x WLL												

Specification`s

	Size WLL	125	150	200	250	300	400	500	600	700	800	900	1000	1250	1550	
Units	1	Tonnes														
	2	Klbs														
Resolution	1	0.01						0.1								
	2	0.02										0.2				
Battery Type	Load Shackle 2 off AA batterys (depending on update rate up to 6 months continuous use) Handset 2 off AA (40 Hours)															
Accuracy	`+/- 1 % of F.S.															
Operating temp	`-10 deg C to +60 deg C															
Enviromental rating	IP67															
Radio Frequency	2.4 GHz ELT24 transmitter, optional receivers. Transmition range 500 mtr depending on site conditions.															
Handset	As standard ELT-24-HS2 2.4 GHz receiver.															
Note: Any 2 units of measurement can be specified at time of order.																
Certification package supplied with each link contains: Calibration Certificate to BS 8422:2003, Declaration of Incorporation, EU Declaration of Conformity, Declaration of Manufacture, EC Declaration of Incorporation, CE- Aproval Statements, Checklist and user instructions. Material Certificates 2.1, 2.2, 3.1.																



ELS-24Heavy Duty P-6043 Telemetry Power Sling Shackle

Local Agent:

Euroload Limited, Unit 9, Airside Business Park, Dyce Drive, Kirkhill Ind Est, Dyce, Aberdeen, AB21 0GT.
Tel: +44 (0) 1224 774115 e-mail info@euroload.eu